

**File No. 1908**  
**Board Order No.1908-1**

---

**August 26, 2016**

**SURFACE RIGHTS BOARD**

IN THE MATTER OF THE *PETROLEUM AND NATURAL GAS ACT*,  
R.S.B.C., C. 361 AS AMENDED

AND IN THE MATTER OF  
THE SOUTH WEST ¼ OF SECTION 8 TOWNSHIP 80 RANGE 14  
WEST OF THE 6TH MERIDIAN PEACE RIVER DISTRICT

(The "Lands")

BETWEEN:

ARC Resources Ltd.

(APPLICANT)

AND:

John Irving Miller

(RESPONDENT)

---

**BOARD ORDER**

---

ARC Resources Ltd. ("ARC") seeks a right of entry order to access certain lands legally owned by John Irving Miller (the "Lands").

ARC requires access to the Lands to construct, operate and maintain a flow line and associated infrastructure.

The parties have advised the Board that they have reached agreement on the right of entry as set out below.

Accordingly, BY CONSENT, the Surface Rights Board orders:

The Surface Rights Board orders:

1. Upon payment of the amount set out in paragraphs 2 and 3, ARC shall have the right to enter and access the portions of the Lands shown outlined in red on the Individual Ownership Plan attached as Appendix "A" as necessary for the purpose of constructing, operating and maintaining a flow line in accordance with British Columbia Oil and Gas Commission Permit No. 9709763.
2. ARC shall pay to the landowner as partial compensation the total amount of \$1,000.
3. ARC shall deliver to the Surface Rights Board security in the amount of \$2,500 by cheque made payable to the Minister of Finance. All or part of the security deposit may be returned to ARC, or paid to the landowner, upon agreement of the parties or as ordered by the Board.
4. ARC will, within seven days of receiving notice of a builder's lien claim being filed against the Lands as a result of the work being carried out by ARC on the subject property, take all reasonable steps to cause the lien to be removed.
5. All vehicles used in the farming operations of the landowner will have a right to cross the pipeline right of way in the normal and ordinary course of such farming operations, regardless of whether the vehicle carries a farm license, provided such vehicles shall not alter the depth of cover over the flow line. If vehicles are required to cross the flow line where additional matting or cover is required upon determination by ARC, on reasonable notice being provided to ARC, ARC will construct the appropriate crossing.
6. No risers or other above ground equipment or structures within the area shown outlined in red in Appendix "A" are permitted without the landowner's consent or a further Board order.

7. ARC shall not erect any power poles or transmission lines within the area outlined in red in Appendix "A", permanently or otherwise, without the landowner's consent or a further Board order.
8. Nothing in this order operates as a consent, permission, approval, or authorization of matters within the jurisdiction of the Oil and Gas Commission.

Dated: August 26, 2016

FOR THE BOARD

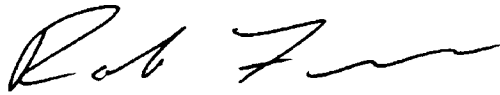
A handwritten signature in black ink, appearing to read "Rob Fraser". The signature is fluid and cursive, with a long horizontal stroke at the end.

---

Rob Fraser, Mediator

**ARC RESOURCES LTD.  
INDIVIDUAL OWNERSHIP PLAN  
SHOWING PROPOSED  
25m PIPELINE RIGHT OF WAY IN  
SW 1/4 Sec 8, Tp 80, R 14, W6M  
PEACE RIVER DISTRICT**

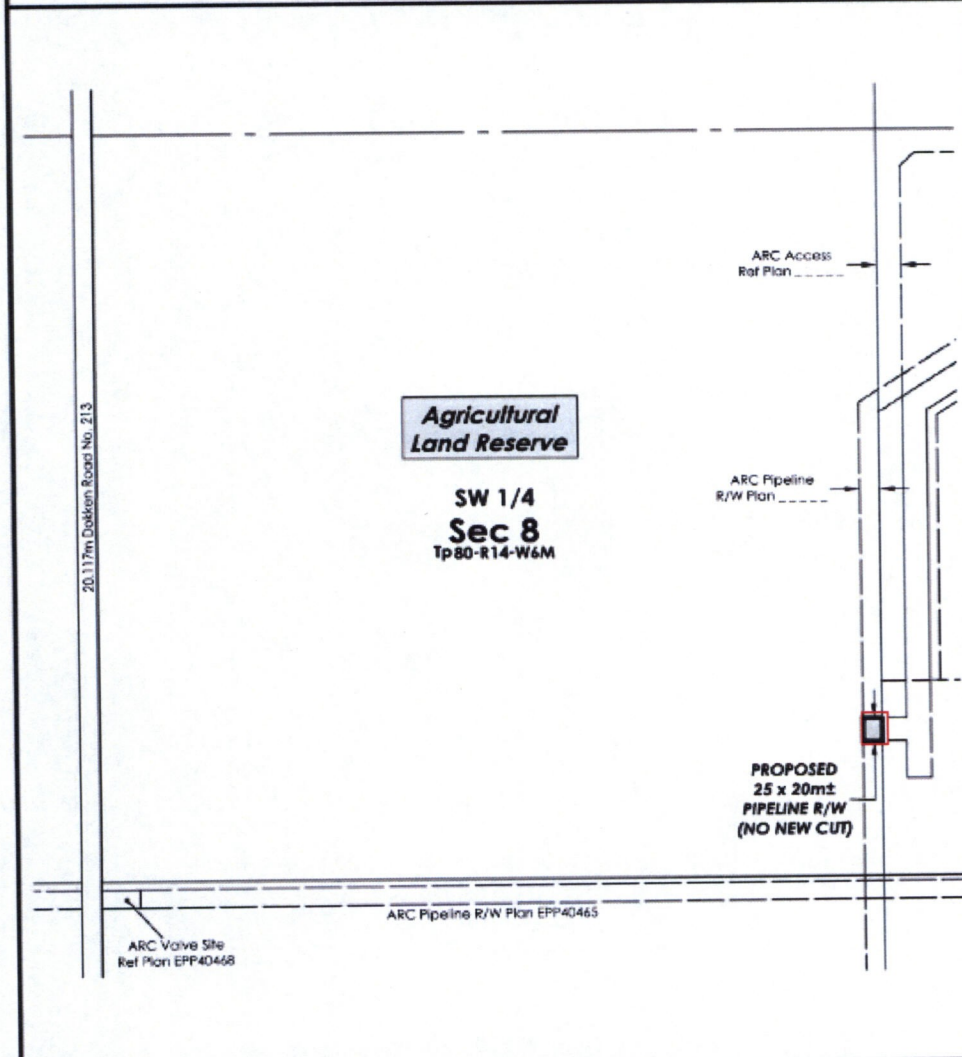

**TITLE No.:** S18293      **P.I.D. No.:** 014-209-811  
**OWNER(S):** John Irving Miller

**LEGEND**  
SCALE = 1 : 5,000  
Portions referred to: .....  
Notes: Distances shown are in metres.  
Certified correct this  
13th day of April, 2016.

**AREA REQUIRED:**  
For 25m Pipeline R/W      0.05 ha    0.12 ac  
**TOTAL:**                      0.05 ha    0.12 ac

*Chris R. Sakundiak*  
Chris R. Sakundiak, BCLS 846



NO	DATE	REVISION	DRN	CKD
0	16/04/13	Original plan issued	SDH	CS

**can-am geomatics**  
can-am geomatics bc  
Fort St. John, B.C.  
www.canam.com

Phone: 250.787.7171  
Toll Free: 1.866.268.0983  
Fax: 250.787.2323

**CAN-AM FILE: J20150678**  
CAD FILE: J20150678/OP10-0  
Client File No.: E12169  
AFE No.:  
Land File No.:  
**REVISION**